

DESCRIPTION:

The JOC302XD5 series combine an AlGaAs infrared emitting diode as the emitter which is optically coupled to a monolithic silicon random-phase photo triac in a plastic DIP5 package with different lead forming options. With the robust coplanar double mold structure, JOC302XD5 series provide the most stable isolation feature. The products are widely used in solenoid/valve controls, lighting controls, motor controls, temperature controls, static AC power switches, solid state relays, interfacing microprocessors up to 120 V_{AC} peripherals.

MAIN FEATURES

High isolation 5000 VRMS

DC input with random-phase photo triac output

Operating temperature range -55 - Z U -

8 + ') . 8 U . 9 I U S V R O G T I K

HBM: H3A; MM: M4

CQC approved

I7 Tc -0.0023 <00520BDC /TT2 1 Tf -13.19 -1.5 2 Tc 05>]TJ 0 Tc 0 Tc 0>>BDC /TT2 1 Tf -136N8.

	Junction Temperature	T_j	125	
	Output Power Dissipation	P_o	250	mW
	Power Dissipation Derating (T_a 125)	$\bullet P_{D/}$	-3.33	mW/
Total Power Dissipation		P_{tot}	350	mW
Isolation Voltage		V_{iso}	5000'	Vrms
Operating Temperature		T_{opr}	-55~100	
Storage Temperature		T_{stg}	-55~125	
Soldering Temperature		T_{sol}	260 ⁸	

NOTE1AC for 1minute, R.H.=40~60%

NOTE2For 10 seconds

ELECTRICAL CHARACTERISTICS (Sample Temperature=25°C)

Parameter		Symbol	Condition	Min.	Typ.	Max.	Unit
Input	Forward Voltage	V_F	$I_F=10mA$	-	1.24	1.4	V
	Reverse Current	I_R	$V_R=6V$	-	-	1	A
	Input Capacitance	C_{in}	$V=0, f=1kHz$	-	10	-	pF
Output	Peak Off-state Current, Either Direction	I_{OFF}	$V_{OFF}=400V, I_F=0$	-	-	100''	nA
	Peak On-state Voltage, Either Direction	V_{TM}	$I_{TM}=100mA$	-	1.8	2.5	V
	Critical Rate of Rise of Off-state voltage	dV/dt	$V_{PEAK}=400V, I_F=0$	1000*	-	-	9 V

LED JOC3021D5

Trigger Current

Transfer Characteristics

ORDERING AND MARKING INFORMATION

MARKING INFORMATION

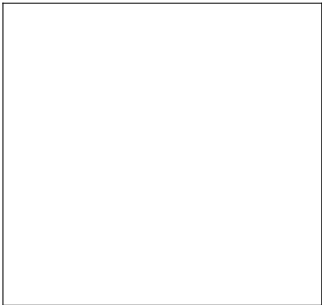

Characteristics Curves

FIG.1: Forward Current vs. Ambient Temperature

FIG.2: On-state Terminal Current vs. Ambient Temperature I_F (

FIG.7: Normalized On-state Terminal Voltage vs. Ambient Temperature

FIG.8: On-state Terminal Voltage vs. On-

TEST CIRCUITS

FIG.12: Test Circuits of Turn On Time

FIG.13: Waveforms of Turn On Time

Fig.14: Test Circuits of dV/dt

Fig.15: Waveforms of dV/dt

Package Dimension (Unit: mm)

Standard DIP Type:

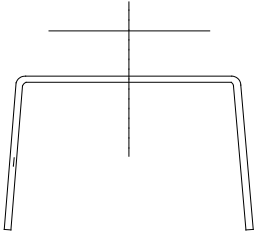

Option S Type:

:91 93.5417699 609.0826605 cm /CS0 CS731.724224S0 CS 35841m -185 809 I S Q q 0.0227635 0 0 -027491 172

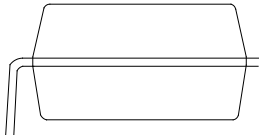

Option SLM Type:

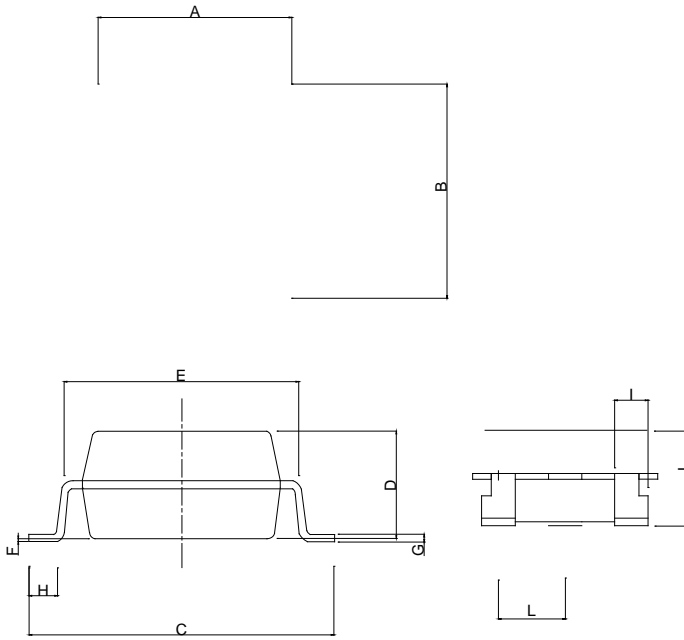

Ref.	Dimensions					
	Millimeters			Inches		
	Min.	Typ.	Max.	Min.	Typ.	Max.
A	6.30		6.70	0.248		0.264
B	6.92		7.32	0.272		0.288
C	11.60		12.10	0.457		0.476
D	3.30		3.70	0.130		0.146
E	7.32		7.92	0.288		0.312
F			0.30			0.012
G						
H	0.50			0.020		
I	1.10		1.30	0.043		0.051
J	3.45		3.85	0.136		0.152
K						

Option SL

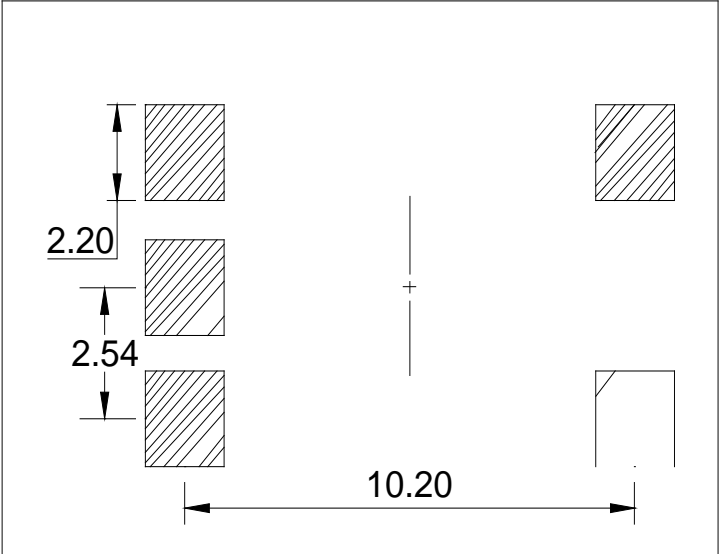

//

/

REFLOW INFORMATION

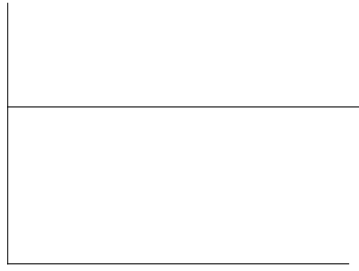

WAVE SOLDERING



HAND SOLDERING BY SOLDERING IRON

Soldering Temperature	360± 5
Soldering Time	3s max.

Document Revision History

Date	Revision	Changes
Apr.2, 2025	A.1.0	Last update
Nov.5, 2025	A.1.1	Add S&SLM package

Information furnished in this document is believed to be accurate and reliable. However, Jiangsu JieJie Microelectronics Co., Ltd. assumes no responsibility for the consequences of use without consideration for such information nor use beyond it. Information mentioned in this document is subject to change without notice, apart from that when an agreement is signed, Jiangsu JieJie complies with the agreement.

Products and information provided in this document have no infringement of patents. Jiangsu JieJie assumes no responsibility for any infringement of other rights of third parties which may result from the use of such products and information. This document supersedes and replaces all information previously supplied.

is a registered trademark of Jiangsu JieJie Microelectronics Co., Ltd.

Copyright © 2025 Jiangsu JieJie Microelectronics Co., Ltd. All rights reserved.